

ORDINANCE NO. 17-14AN ORDINANCE AMENDING ORDINANCE NO. 16-94

WHEREAS, Ordinance No. 16-94 was passed and approved on March 22, 1994, for the purpose of annexing certain territory into the City of Fort Smith; and

WHEREAS, the owners of certain property described in Ordinance No. 16-94 did not participate in the original petition to annex property as described in Ordinance No. 16-94; yet by scrivener's error, the owners' real property was included in the legal description contained in the Ordinance;

NOW THEREFORE, BE IT ORDAINED AND ENACTED by the Board of Directors of the City of Fort Smith, Arkansas, that Ordinance No. 16-94 is hereby amended to state the legal description of the real property being annexed as follows:

Lot 1, Bieker Business Center Addition to the Greenwood District of Sebastian County, Arkansas.

AND

The East Half (E ½) of the Northeast Quarter (NE ¼) of Section 2, Township 7 North, Range 32 West to Sebastian County, Arkansas.

AND

The West Half (W ½) of the Southeast Quarter (SE ¼); the Southeast Quarter (SE ¼) of the Southeast Quarter (SE ¼) and the West Half (W ½) of the Northeast Quarter (NE ¼) of the Southeast Quarter (SE ¼), all in Section 2, Township 7 North, Range 32 West, Sebastian County, Arkansas, more particularly described as follows:

Beginning at the Northwest corner of said W ½ of the NE ¼ of the SE ¼; thence South 88°05' East, 658.0 feet along the North line of said W ½ of the NE ¼ of the SE ¼ to the Northeast corner thereof; thence South 01°47' West, 1325.1 feet along the East line of said W ½ of the NE ¼ of the SE ¼ to the Southeast corner of said W ½ of the NE ¼ of the SE ¼; thence South 88°03' East, 658.0 feet to the Northeast corner of said SE ¼ of the SE ¼; thence South 01°47' West, 1325.5 feet along the East line of said SE ¼ of the SE ¼ to the Southeast corner of the said SE ¼ of the SE ¼; thence North

88°02' West, 2635.7 feet to the Southwest corner of said W ½ of the SE ¼; thence North 01°45' East, 2648.2 feet to the Northwest corner of said W ½ of the SE ¼; thence South 88°05' East, 1321.0 feet to the point of beginning, containing 140.34 acres more or less;

LESS AND EXCEPT:

That portion of Section 2 lying in the Northeast Quarter of the Northeast Quarter of Section 2, Township 7 North, Range 32 West located north and east of Old Greenwood Road and south of Zero Street.

PASSED AND APPROVED THIS 18th DAY OF February, 2014.

APPROVED:



ATTEST:

City Clerk

Approved as to form:



City Attorney
Walsh 1 Time

Exhibit A

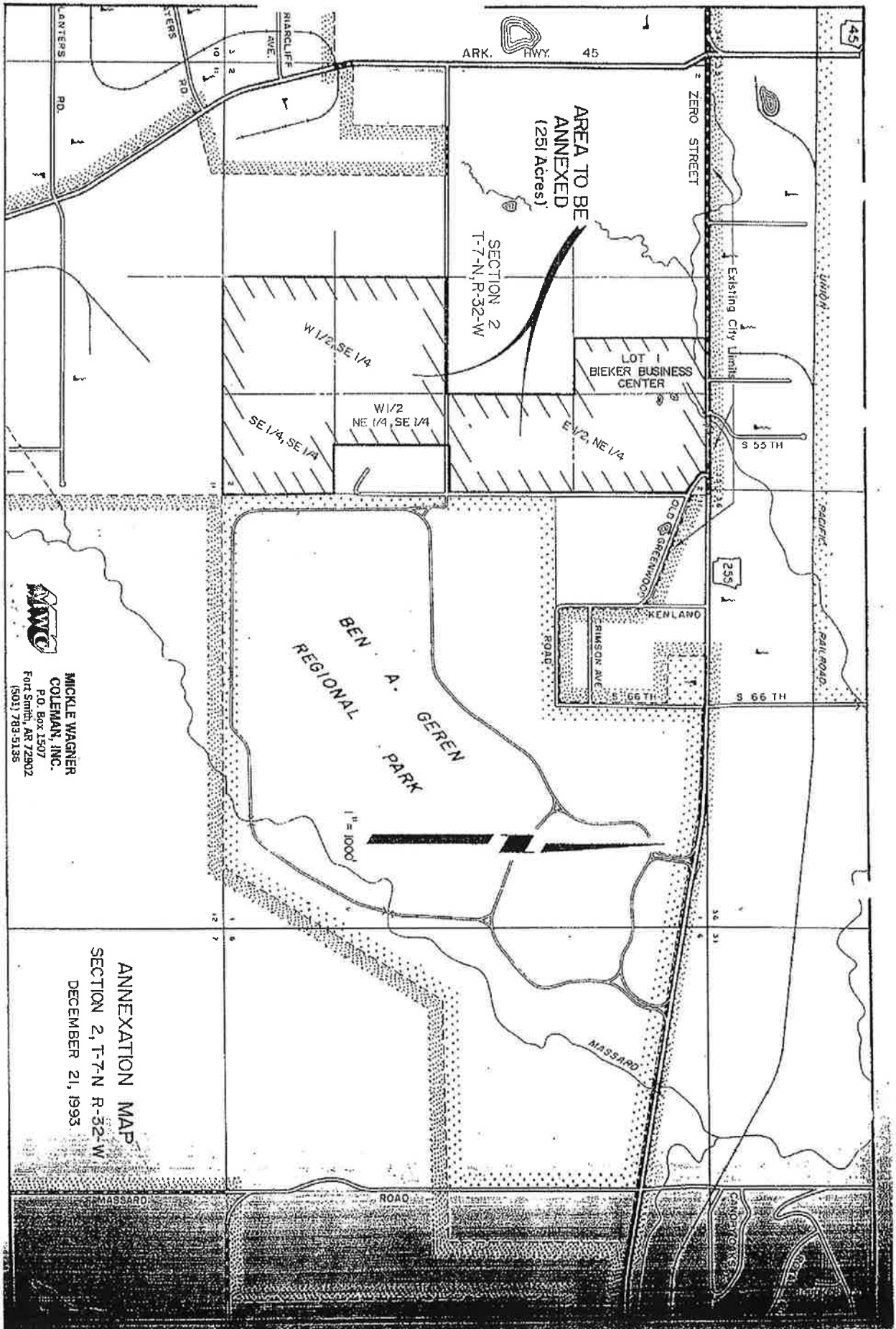

Exhibit C

