

RURAL DISTRICT

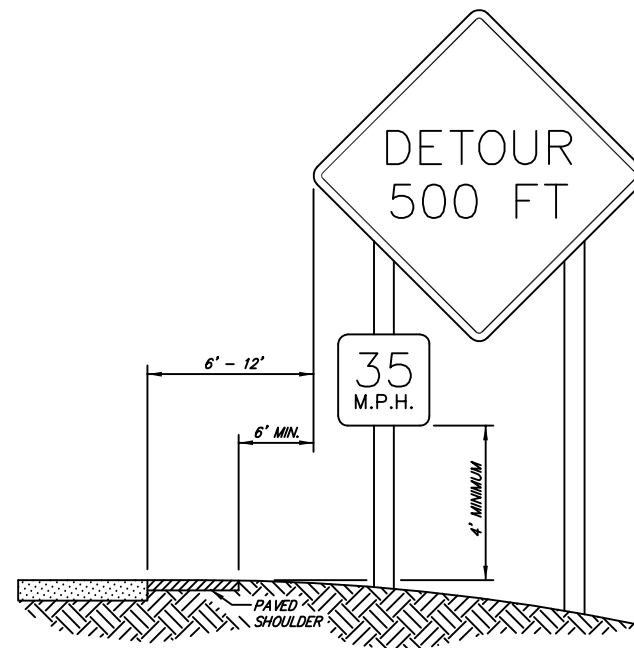

RURAL DISTRICT WITH  
ADVISORY SPEED PLATE

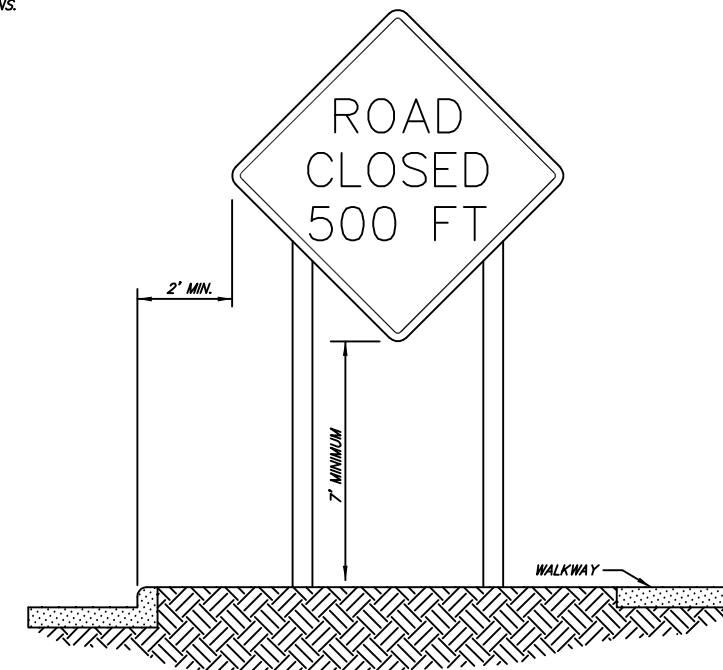

URBAN DISTRICT

NOTE:

1. TEMPORARY SIGNS MAY BE GROUND MOUNTED ON BARRICADES FOR SHORT-TERM, SHORT DURATION AND MOBILE OPERATIONS. THEY SHOULD NOT BE USED FOR MORE THAN 3 DAYS EXCEPT AS NOTED IN THE MUTCD. PORTABLE SUPPORTS SHALL NOT BE USED.
2. BARRICADE MOUNTED SIGNS SHALL BE MOUNTED A MINIMUM OF 1 FT ABOVE PAVEMENT EDGE AND LOCATED LATERALLY THE SAME AS POST MOUNTED SIGNS.

SIGN HEIGHT AND  
LATERAL LOCATION

N.T.S.  
TC.1.1

SPACING = 2 x POSTED SPEED  
LIMIT OR AS NOTED ON PLANS

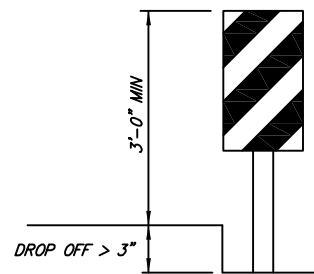

VERTICAL PANEL PLACEMENT

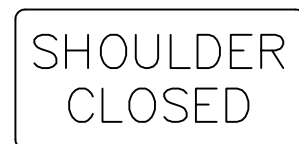

48"x30"  
RSP-1

TRAFFIC CONTROL DEVICES FOR  
VERTICAL PAVEMENT DIFFERENTIALS

N.T.S.  
TC.1.2

VERTICAL DIFFERENTIAL	LOCATIONS	TRAFFIC CONTROL
1" TO 3"	CENTERLINE, LANE LINES	WB-11
1" TO 3"	EDGE OF SHOULDER,	WB-9
GREATER THAN 3"	LANE LINES	STANDARD LANE CLOSURE REQUIRED
GREATER THAN 3"	EDGE OF TRAVELED LANE	RSP-1 AND VERTICAL PANELS, DRUMS OR CONCRETE BARRIER
GREATER THAN 3"	EDGE OF SHOULDER,	VERTICAL PANELS, DRUMS OR CONCRETE BARRIER

GENERAL NOTES:

1. TEMPORARY TRAFFIC CONTROL PLANS SHOW ON THESE SHEETS REFLECT TYPICAL SITUATIONS ENCOUNTERED FOR CITY OF FORT SMITH PROJECTS. FOR SITUATIONS WHICH MAY DEVIATE FROM THESE TYPICAL PLANS SHOWN, CONTRACTOR SHALL SUBMIT A TRAFFIC CONTROL PLAN FOR REVIEW BY THE ENGINEER.
2. ALL TRAFFIC CONTROL DEVICES USED SHALL CONFORM TO THE MANUAL ON UNIFORM TRAFFIC CONTROL DEVICES FOR STREETS AND HIGHWAYS, AND TO STANDARD HIGHWAY SIGNS, LATEST EDITION AS APPROVED BY THE FEDERAL HIGHWAY ADMINISTRATION AND AS NOTED ON THESE DRAWINGS.
3. TRAFFIC CONTROL DEVICES SHALL BE SET UP PRIOR TO THE START OF CONSTRUCTION OPERATIONS AND SHALL BE PROPERLY MAINTAINED AT ALL TIMES. ALL TEMPORARY TRAFFIC CONTROL DEVICES SHALL BE REMOVED AS SOON AS PRACTICAL WHEN THEY ARE NO LONGER NEEDED. WHEN WORK IS SUSPENDED FOR SHORT PERIODS OF TIME, TEMPORARY TRAFFIC CONTROL DEVICES THAT ARE NO LONGER APPROPRIATE SHALL BE REMOVED OR COVERED.
4. SIGNS SHALL BE KEPT IN PROPER POSITION, CLEAN AND LEGIBLE AT ALL TIMES. SIGNS THAT DO NOT APPLY TO EXISTING CONDITIONS SHALL BE REMOVED. DAMAGED, DEFACED OR DIRTY SIGNS SHALL BE CLEANED, REPAIRED OR REPLACED.
5. SIGNS ARE USUALLY MOUNTED ON A SINGLE POST, ALTHOUGH THOSE WIDER THAN 36" OR LARGER THAN 10 S.F. SHALL BE MOUNTED ON TWO POSTS OR ABOVE A TYPE III OR WING BARRICADE.
6. ALL MOUNTING POSTS SHALL BE 4"x4" WOOD, BE PAINTED WHITE, BE NEATLY CONSTRUCTED, BE CLEANED OR REPAIRED AS NEEDED AND KEPT IN GOOD REPAIR FOR THE DURATION OF THE JOB. A 2 LB. CHANNEL POST ASSEMBLY MAY BE USED IN LIEU OF THE 4"x4" POST. IF 2 LB. CHANNEL POSTS ARE USED, THERE SHALL NOT BE MORE THAN 3 POSTS IN AN 8' PATH, AND ANY POST SPLICE SHALL HAVE A MINIMUM DISTANCE OF 30" BETWEEN THE BOTTOM OF THE SPLICE AND THE GROUND. PORTABLE SIGN SUPPORTS (SKIDS) MAY BE CONSTRUCTED OF 2" X 4" WOOD PROVIDED SUFFICIENT BRACING IS USED.
7. SIGN SHEETING MATERIAL SHALL COMPLY WITH AASHTO M268 TYPE IX (MP GRADE) RETROREFLECTION SHEETING. SIGN MATERIAL (SUBSTRATE) SHALL BE STEEL, ALUMINUM OR PLYWOOD OF SUFFICIENT THICKNESS AND STABILITY TO MAINTAIN A SUBSTANTIAL, EFFECTIVE SIGN FOR THE DURATION OF THE PROJECT. LETTERS, BORDERS AND SPACING FOR SIGNS SHALL CONFORM TO THE REQUIREMENTS IN STANDARD HIGHWAY SIGNS, LATEST REVISION.
8. ADVANCE WARNING SIGNS SHALL HAVE BLACK LEGEND AND BORDER ON ORANGE REFLECTORIZED BACKGROUND. REGULATORY SIGNS SHALL HAVE BLACK LEGEND AND BORDER ON WHITE REFLECTORIZED BACKGROUND. GUIDE SIGNS SHALL HAVE A WHITE LEGEND ON A GREEN REFLECTORIZED BACKGROUND.

By	Date	Revision

Standard Drawings  
TRAFFIC CONTROL  
Public Works Construction

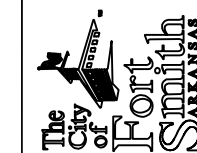

CITY OF FORT SMITH  
Engineering Department  
623 Garrison Avenue, Room 409  
Fort Smith, Arkansas 72901  
Phone (479)784-2225 Fax (479)784-2245

Project:	Details
Date:	NOV 2012
Scale:	As Shown
Drawn By:	RBR
Dwg. No.:	TC1
Sheet No.:	24